

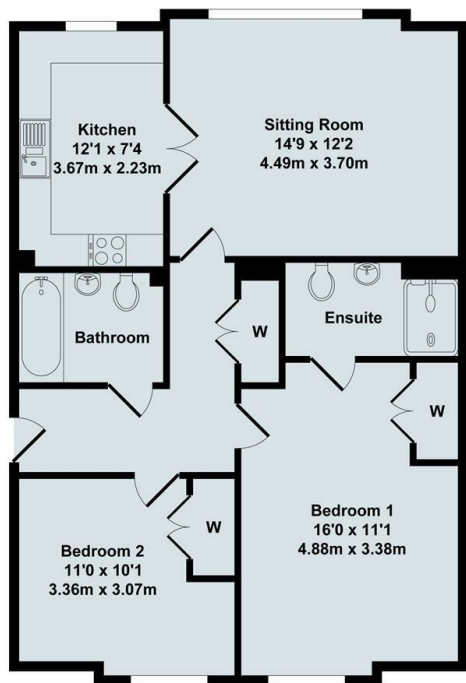

14 Priory Court, Jackson Road, Oxford, OX2 7UW

£1,600 PCM

- Two bedrooms
- Gas CH
- Council Tax Band C
- Two bathrooms
- Parking for 1 car
- Fully furnished
- EPC rating C



Total Approx. Floor Area 741 Sq.Ft. (68.80 Sq.M.)
All items illustrated on this plan are included in the "Total Approx Floor Area"



Directions

Viewings

Viewings by arrangement only. Call 01865 515900 to make an appointment.

Council Tax Band

C

EPC Rating:

C

Energy Efficiency Rating		
	Current	Potential
Very energy efficient - lower running costs		
(92-plus) A		
(81-91) B	78	80
(69-80) C		
(55-68) D		
(39-54) E		
(21-38) F		
(1-20) G		
Not energy efficient - higher running costs		
England & Wales	EU Directive 2002/91/EC	